

National Seal Systems Ltd Newsletter

May 2014

National Seal Systems Ltd present Barrierfold, Top Hung folding sliding patio door hardware.

Barrierfold is suitable for Commercial folding door partitions in applications such as between communal areas.

A folding system for patio doors. Components are made from stainless steel with a brushed stainless finish, 25 micron anodised aluminium track and channel (pvc insert in channel) and tough durable nylon wheels for a smooth quiet operation. Also the system has complete adjustment capabilities at every hanger and pivot point. Easy to specify and is available in both satin stainless and polished gold PVD finishes

Materials:-

Aluminium anodised top track, 4 wheel hangers with Nylon tyred wheels, Stainless Steel Hinges and solid Brass bodied flush bolts in either Satin Stainless or Polished Gold PVD finishes.



See Technical Data Sheets on the following pages.

Barrierfold



Note: even leaf systems can now have equal width leaves throughout

| | |
|-------------------------|------------|
| Maximum number of doors | 7 each way |
| Maximum door weight | 90 kg |
| Maximum door width | 1000 mm |
| Maximum opening width | 14000 mm |
| Maximum door height | 3300 mm |
| Minimum door thickness | 35 mm |

A folding system for patio doors. Components are made from stainless steel with a brushed stainless finish, 25 micron anodised aluminium track and channel (pvc insert in channel) and tough durable nylon wheels for a smooth quiet operation. Also the system has complete adjustment capabilities at every hanger and pivot point. Easy to specify and is available in both satin stainless and polished gold PVD finishes.



Knuckle Design

Barrierfold has been designed so that where possible all knuckles are suited with double bearings, including the pivot plates and end hangers. Only the meeting hardware has solid knuckles due to the interlocking design.



Gold PVD finish

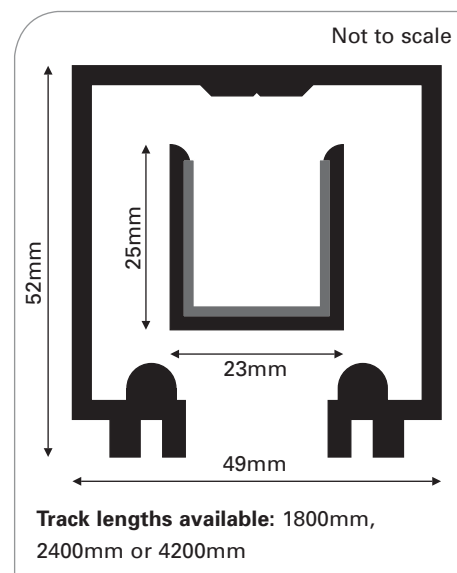

Ideal for: Folding patio doors

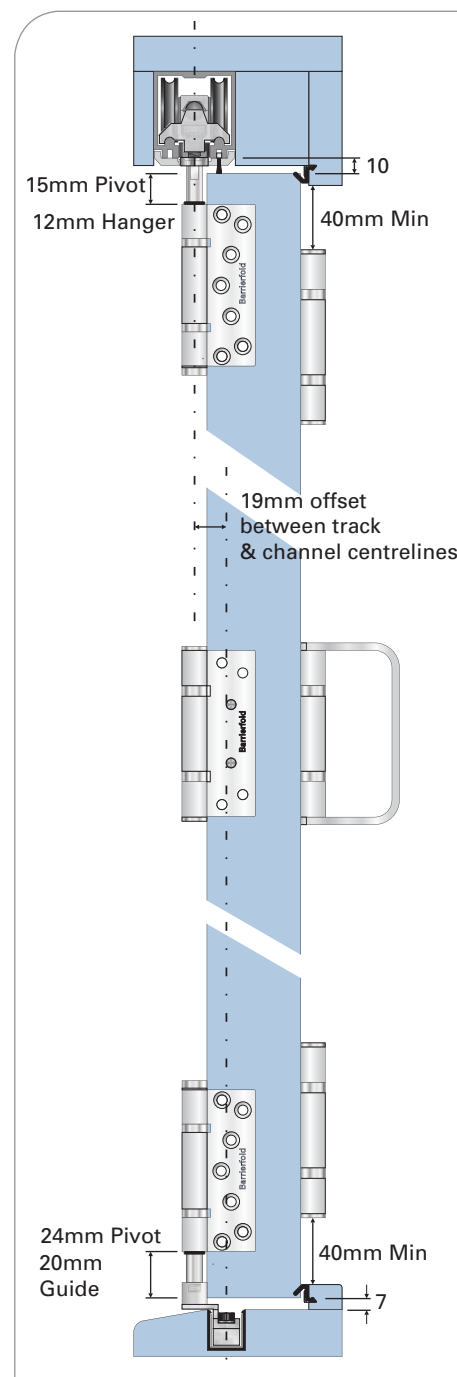

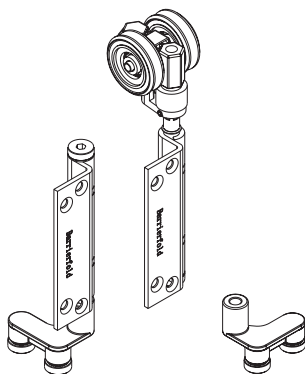

BFD-END

Kit Comprises of;

- 1 x End Hanger c/w bearing flaps
- 1 x End Guide c/w bearing flaps and LH/RH Foot plate

For use when end leaf closes to a Jamb.

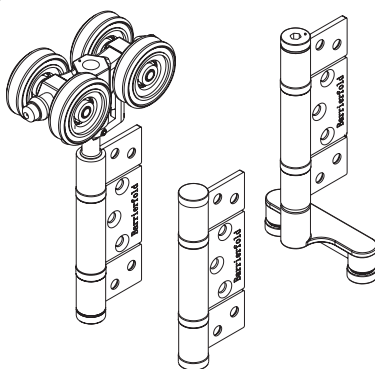

BFD-HHG

Kit comprises of;

- 1 x Intermediate hanger
- 1 x Hinge
- 1 x Intermediate Guide

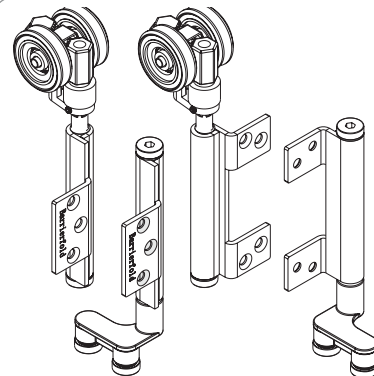

BFD-MHS

Kit comprises of:

- 1 Set of meeting hangers
- 1 Set of meeting guides

Designed for 2+2 or 4+4 layouts.

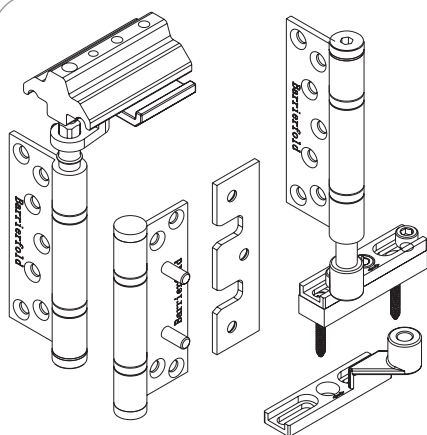

BFD-PVT

Kit comprises of:

- 1 x Top pivot c/w bearing knuckle
- 1 x Middle pivot hinge c/w bearing knuckle
- 1 x Bottom pivot set c/w bearing knuckle

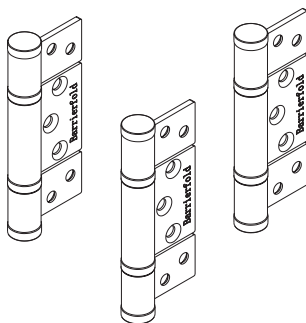

BFD-HSI / BFD-OHSI

Kit comprises of:

- HSI = 3 x Standard Hinges
- OHSI = 3 x Offset Hinges

For doors folding inwards

1 x OHSI needed on last hinge/break point before a 2 wheel end or meeting hanger

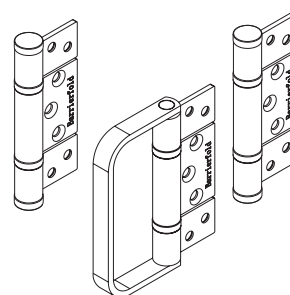

BFD-HSE

Kit comprises of;

- HSE = 2 Standard Hinges & 1 Standard Hinge Handle.
- OHSE = 2 x Offset Hinges & 1 Offset Hinge Handle.

For doors folding outwards.

1 x OHSE needed on last hinge/break point before a 2 wheel end or meeting hanger

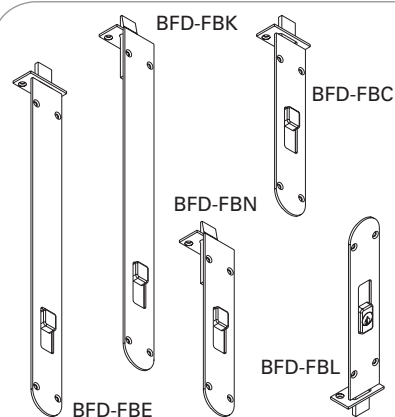

Barrierfold Flush Bolt Range

- BFD-FBN Standard flush bolt 210mm
- BFD-FBL Locking flush bolt 210mm
- BFD-FBC Cranked flush bolt 210mm
- BFD-FBE Extended flush bolt 210mm
- BFD-FBK Extended cranked flush bolt 400mm

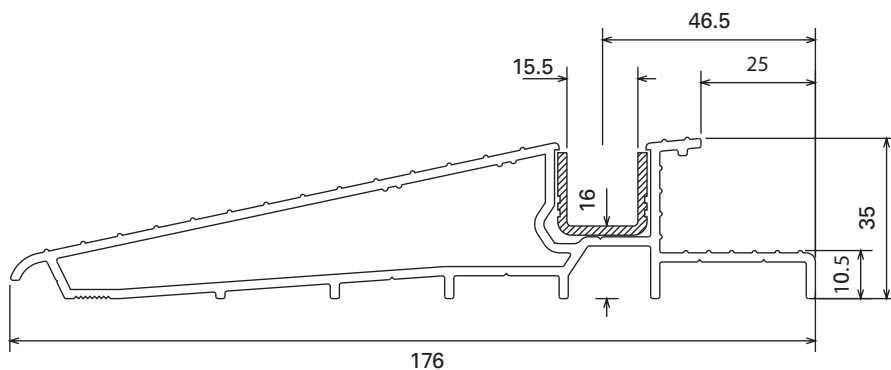

Aluminium self draining bottom threshold with Pvc Channel Insert

Alternative solution which replaces the need of a timber threshold with channel. Profile allows water to drain away from the channel. Satin Anodised finish. Available in 1800mm, 2400mm and 4200mm lengths.



Barrierfold components

Odd Door Layout

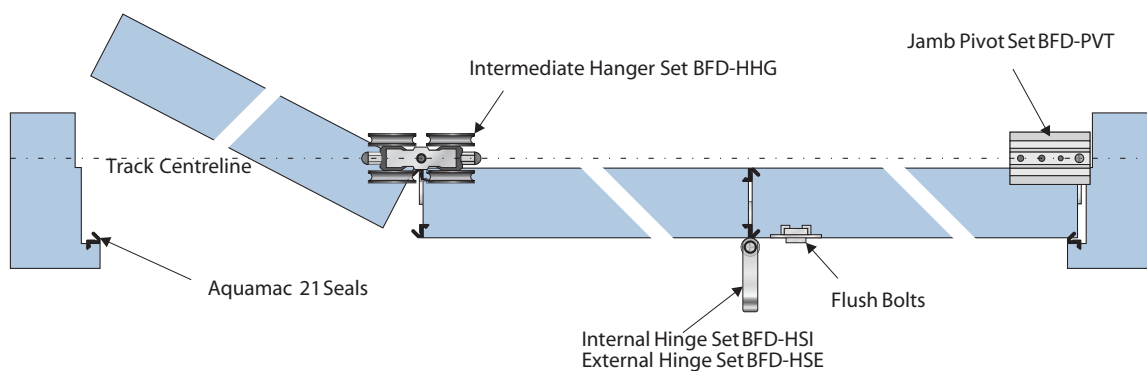

Even Leaf Layout

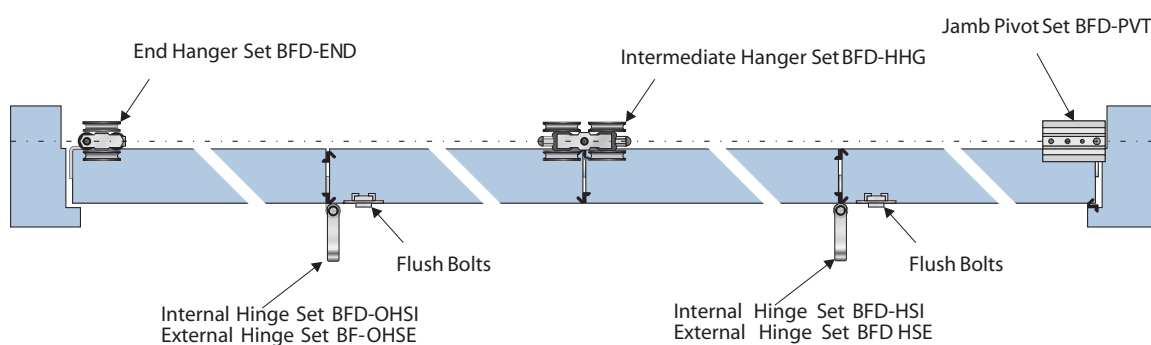

Even Meeting Sets Layout

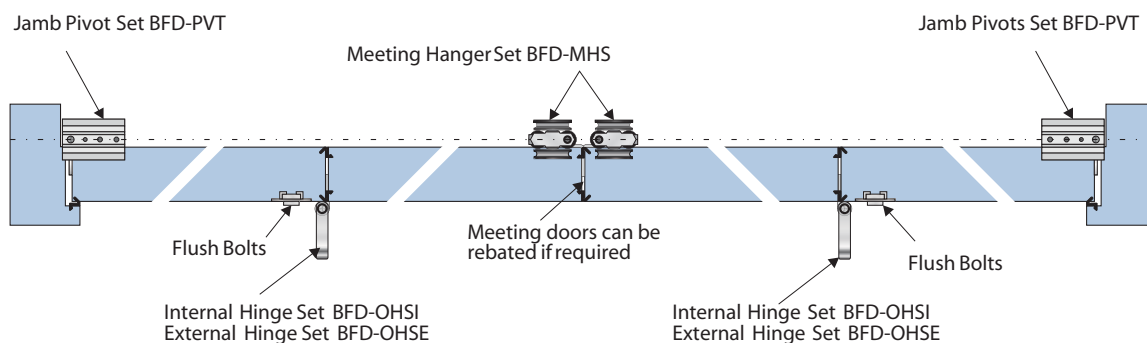

Please allow the following clearances;
 Door to Door = 3mm Door to Jamb = 7mm
 Meeting doors on bi-parting layouts = 7mm

Please note even leaves can now be used by placing offset hinges to the last hinge/break point before a 2 wheel end or meeting hanger
 Should you require assistance please call our office for further details.

Barrierfold kit selection

To select your hardware you must;

1. Select required track pack and length from below
(Tracks can be joined).

2. Select the correct hardware based upon door layout and finish.

3. Weatherseals, brush strips and locks are also available -
call our sales office for details.

| Track Pack Options | 1800mm | 2400mm | 4200mm |
|-----------------------------|----------|----------|----------|
| Top Track and Channel Set | BFD-TC18 | BFD-TC24 | BFD-TC42 |
| Top Track and Threshold Set | BFD-TT18 | BFD-TT24 | BFD-TT42 |

| Layout | Options | Satin Stainless | PVD Gold |
|--|----------------------|-----------------|------------|
|  Single Swing Door | Under 2.4m | BFD-1U-S | BFD-1U-G |
| | Over 2.4m | BFD-1O-S | BFD-1O-G |
|  2 Door Layout | Outward / Under 2.4m | BFD-2OU-S | BFD-2OU-G |
| | Inward / Under 2.4m | BFD-2IU-S | BFD-2IU-G |
| | Outward / Over 2.4m | BFD-2OO-S | BFD-2OO-G |
| | Inward / Over 2.4m | BFD-2IO-S | BFD-2IO-G |
|  3 Door Layout | Outward / Under 2.4m | BFD-3OU-S | BFD-3OU-G |
| | Inward / Under 2.4m | BFD-3IU-S | BFD-3IU-G |
| | Outward / Over 2.4m | BFD-3OO-S | BFD-3OO-G |
| | Inward / Over 2.4m | BFD-3IO-S | BFD-3IO-G |
|  4 Door Layout | Outward / Under 2.4m | BFD-4OU-S | BFD-4OU-G |
| | Inward / Under 2.4m | BFD-4IU-S | BFD-4IU-G |
| | Outward / Over 2.4m | BFD-4OO-S | BFD-4OO-G |
| | Inward / Over 2.4m | BFD-4IO-S | BFD-4IO-G |
|  5 Door Layout | Outward / Under 2.4m | BFD-5OU-S | BFD-5OU-G |
| | Inward / Under 2.4m | BFD-5IU-S | BFD-5IU-G |
| | Outward / Over 2.4m | BFD-5OO-S | BFD-5OO-G |
| | Inward / Over 2.4m | BFD-5IO-S | BFD-5IO-G |
|  6 Door Layout | Outward / Under 2.4m | BFD-6OU-S | BFD-6OU-G |
| | Inward / Under 2.4m | BFD-6IU-S | BFD-6IU-G |
| | Outward / Over 2.4m | BFD-6OO-S | BFD-6OO-G |
| | Inward / Over 2.4m | BFD-6IO-S | BFD-6IO-G |
|  7 Door Layout | Outward / Under 2.4m | BFD-7OU-S | BFD-7OU-G |
| | Inward / Under 2.4m | BFD-7IU-S | BFD-7IU-G |
| | Outward / Over 2.4m | BFD-7OO-S | BFD-7OO-G |
| | Inward / Over 2.4m | BFD-7IO-S | BFD-7IO-G |
|  2+2 Door Layout | Outward / Under 2.4m | BFD-22OU-S | BFD-22OU-G |
| | Inward / Under 2.4m | BFD-22IU-S | BFD-22IU-G |
| | Outward / Over 2.4m | BFD-22OO-S | BFD-22OO-G |
| | Inward / Over 2.4m | BFD-22IO-S | BFD-22IO-G |
|  4+4 Door Layout | Outward / Under 2.4m | BFD-44OU-S | BFD-44OU-G |
| | Inward / Under 2.4m | BFD-44IU-S | BFD-44IU-G |
| | Outward / Over 2.4m | BFD-44OO-S | BFD-44OO-G |
| | Inward / Over 2.4m | BFD-44IO-S | BFD-44IO-G |